

Tencon Case Study: 2 Storey Detached House

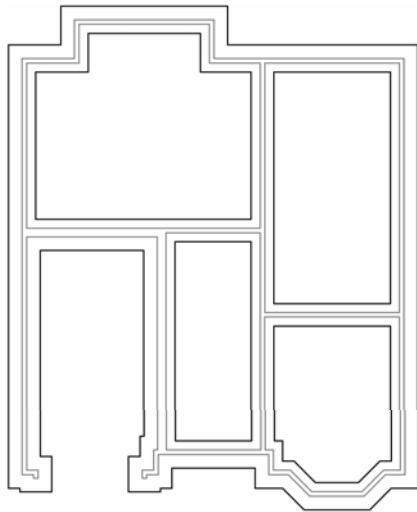

Foundation Layout For Suspended Steel RF Slab



Key Design Facts

- Slab area: 90 m²
- Slab depth: 150 mm
- “Normal” concrete: 13.5 m³
- Foundation runs: **58.6 m**

*Foundation Layout For **Tencon** Suspended Slab*

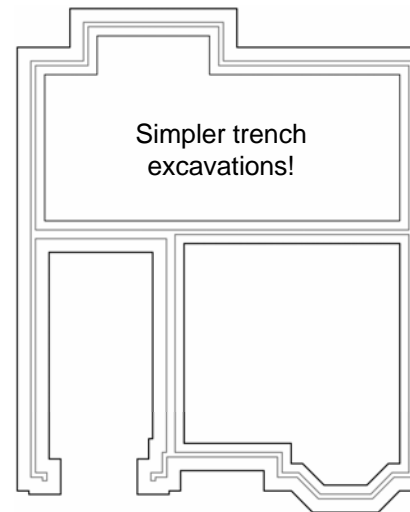

Key Design Facts

- Slab area: 90 m²
- Slab depth: 150 mm
- **Tencon** concrete: 13.5 m³
- Foundation runs: **49.9 m**

- The Tencon Floor System gave a **saving of 8.7m (15%) of foundation runs**
 - Cost savings and easier excavations are achieved
- No steel mesh required on site for slab construction: **easier slab installations possible**
 - Half a day of steel mesh fixing time is saved when using Tencon Concrete
 - Tencon Concrete’s cost is roughly equivalent to “normal” concrete and steel mesh costs