



With Tencon Concrete (Supplied By CEMEX)

Slab Load Capacity kN/m^2 With Unfactored / Actual Load

Slab Thickness
t = 150mm

Slab Bearing Length (mm)	B	A =	2.50m	3.00m	3.50m	4.00m	4.50m	5.00m	5.50m	6.00m	6.50m	7.00m	7.50m	8.00m
b = 100	2.50m		29.25	19.50	16.50	14.75	13.75	13.25	12.75	12.50	12.50	12.50	12.50	12.50
b = 150 or 215			36.00	27.00	22.00	20.00	18.50	17.75	17.25	17.00	17.00	17.00	17.00	17.00
b = 100	3.00m		19.50	16.25	12.50	10.75	9.50	8.75	8.25	8.00	7.75	7.50	7.50	7.50
b = 150 or 215			27.00	21.75	17.00	14.25	12.50	11.00	10.75	10.50	10.25	10.00	10.00	10.00
b = 100	3.50m		16.50	12.50	10.75	8.50	7.25	6.50	5.75	5.50	5.25	5.00	4.75	4.75
b = 150 or 215			22.50	17.00	14.00	11.00	9.25	8.25	7.50	7.00	6.50	6.50	6.25	6.25
b = 100	4.00m		14.75	10.75	8.50	7.50	6.00	5.00	4.25	3.75	3.50	3.25	3.00	
b = 150 or 215			20.00	14.25	11.00	9.50	7.50	6.25	5.50	4.75	4.50	4.25	4.25	
b = 100	4.50m		13.75	9.50	7.75	6.00	5.00	4.00	3.25	2.75	2.50			
b = 150 or 215			18.50	12.50	9.25	7.50	6.50	5.00	4.25	3.50	3.25			
b = 100	5.00m		13.25	8.75	6.50	5.00	4.00	3.50	2.75	2.00				
b = 150 or 215			17.75	11.50	8.25	6.25	5.00	4.25	3.50	2.75				
b = 100	5.50m		12.75	8.25	5.75	4.25	3.25	2.75	2.25					
b = 150 or 215			17.25	10.75	7.50	5.50	4.25	3.50	3.00					
b = 100	6.00m		12.50	8.00	5.50	3.75	2.75	2.50						
b = 150 or 215			17.00	10.50	7.00	4.75	3.50	2.75						
b = 100	6.50m		12.50	7.75	5.25	3.50	2.00							
b = 150 or 215			17.00	10.25	6.50	4.50	3.25							
b = 100	7.00m		12.50	7.75	5.00	3.25								
b = 150 or 215			17.00	10.00	6.50	4.25								
b = 100	7.50m		12.50	7.50	4.75	3.00								
b = 150 or 215			17.00	10.00	6.25	4.25								
b = 100	8.00m		12.50	7.50	4.75									
b = 150 or 215			17.00	10.00	6.00									

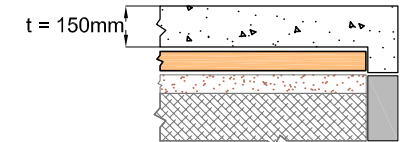
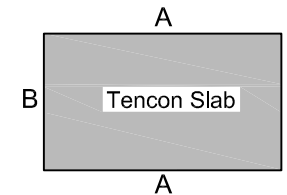

Slab Bearing b = 100mm

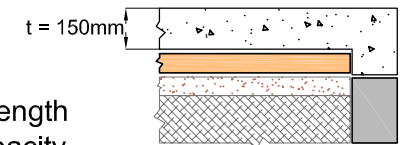

Slab Bearing b = 150mm

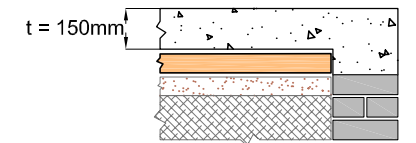

Slab Bearing b = 215mm

Note: Slab bearing length affects slab load capacity

- 1- Load factors in accordance with BS EN 1992-1-1:2004 are incorporated in the above table; 1.35 for dead loads and 1.50 for imposed loads.
- 2- When allowing for the provision of a lightweight partition wall (100mm thick timber stud, faced with plasterboard and a skim coat or equivalent) at any location on the floor, subtract 1.0kN/m^2 from the above figures.
- 3- Floors incorporating block partition walls or structural partitions should be designed in accordance with Section 4.5 of the Tencon BBA Certificate (05/4257).



With Tencon Concrete (Supplied By CEMEX)

Slab Load Capacity kN/m² With Unfactored / Actual load

Slab Thickness
t = 225mm

Slab Bearing Length (mm)	B	A =	2.50m	3.00m	3.50m	4.00m	4.50m	5.00m	5.50m	6.00m	6.50m	7.00m	7.50m	8.00m
b = 150	2.50m		96.00	48.50	42.00	38.00	36.00	34.50	33.50	33.00	32.50	32.50	32.50	32.50
b = 215			98.00	74.00	62.00	58.00	52.00	49.00	48.00	47.00	45.00	45.00	45.00	45.00
b = 150	3.00m		48.50	41.00	33.50	29.00	26.00	24.50	23.00	22.50	22.00	21.50	21.50	21.00
b = 215			74.00	60.00	47.00	40.00	35.00	32.50	31.00	30.00	29.00	28.00	28.00	28.00
b = 150	3.50m		42.00	33.50	28.50	24.00	21.50	18.50	17.00	16.00	15.50	15.00	15.00	14.50
b = 215			62.00	47.00	38.50	31.50	27.00	24.00	22.00	21.00	20.00	19.00	18.50	18.50
b = 150	4.00m		38.00	29.00	24.00	20.50	17.50	15.00	13.50	12.50	11.50	11.00	10.50	10.50
b = 215			58.00	40.00	31.50	27.25	22.00	19.00	17.00	15.50	14.25	13.75	13.75	13.00
b = 150	4.50m		36.00	26.00	21.50	17.50	15.50	13.00	11.00	10.00	9.00	8.50	8.25	7.75
b = 215			52.00	35.00	27.00	22.00	19.00	16.00	14.00	12.25	11.00	10.50	9.50	9.25
b = 150	5.00m		34.50	24.50	18.50	15.00	13.00	11.50	9.50	8.50	7.50	7.00	6.50	6.00
b = 215			49.00	32.50	24.00	19.00	16.00	14.50	12.00	10.25	9.50	8.25	7.50	6.00
b = 150	5.50m		33.50	23.00	17.00	13.50	11.00	9.50	8.50	7.50	6.25	5.50	5.00	
b = 215			48.00	31.00	22.00	17.00	14.00	12.00	10.50	8.75	7.50	6.75	6.00	
b = 150	6.00m		33.00	22.50	16.00	12.50	10.00	8.50	7.50	6.50	5.25			
b = 215			47.00	30.00	21.00	15.50	12.25	10.25	8.75	7.75	6.50			
b = 150	6.50m		32.50	22.00	15.50	11.50	9.00	7.50	6.25	5.25				
b = 215			45.00	29.00	20.00	14.25	11.00	9.25	7.50	6.50				
b = 150	7.00m		32.50	21.50	15.00	11.00	8.50	7.00	5.50					
b = 215			45.00	28.00	19.00	13.75	10.50	8.25	6.75					
b = 150	7.50m		32.50	21.50	15.00	11.00	8.50	7.00	5.50					
b = 215			45.00	28.00	18.50	13.75	9.75	7.50	6.00					
b = 150	8.00m		32.00	21.50	14.50	10.50	7.75	6.00						
b = 215			45.00	28.00	18.50	13.00	9.25	6.00						

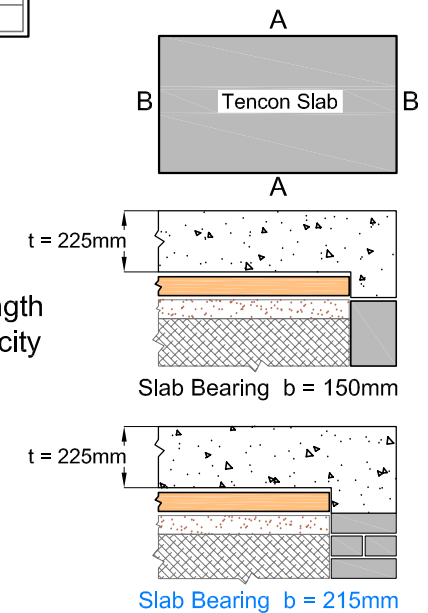

Note: Slab bearing length affects slab load capacity

- 1- Load factors in accordance with BS EN 1992-1-1:2004 are incorporated in the above table: 1.35 for dead loads and 1.50 for imposed loads.
- 2- When allowing for the provision of a lightweight partition wall (100mm thick timber stud, faced with plasterboard and a skim coat or equivalent) at any location on the floor, subtract 1.0kN/m² from the above figures.
- 3- Floors incorporating block partition walls or structural partitions should be designed in accordance with Section 4.5 of the Tencon BBA Certificate (05/4257).